



## TE1 Electric Cart Attachment

Mobile roll handling cart designed to quickly and safely lift, rotate and maneuver a roll.



### **POWER REQUIREMENTS**

Unit integrated with on board battery. Cart plugs into standard 110V wall outlet to charge.

### **SPEED**

Approximately 10 seconds per tip.

### **TIPPING RESTRICTIONS**

No limit to cycles per hour.

### **WEIGHT**

Attachment weighs 226lbs

### **CAPACITY**

See Chart on page 2.

### **CONTROLS**

Tip up/ Tip down, Mast up/ Mast down, and tooth release controls located near push handles

### **PROBE**

All Tip Lifts probes are interchangeable. Probes Feature a patented design that prevents a roll from being release unless the weight of the roll is supported. This prevent unintentionally releasing the roll when the operator is not ready.



Tilt Lock, LLC  
sales@tiltlock.com  
800-999-8458  
www.tiltlock.com

Tilt Lock, LLC will not assume liability for injuries or damage arising from, or caused by, the removal of any safety devices by user.

© Copyright 2018, Tilt Lock, LLC



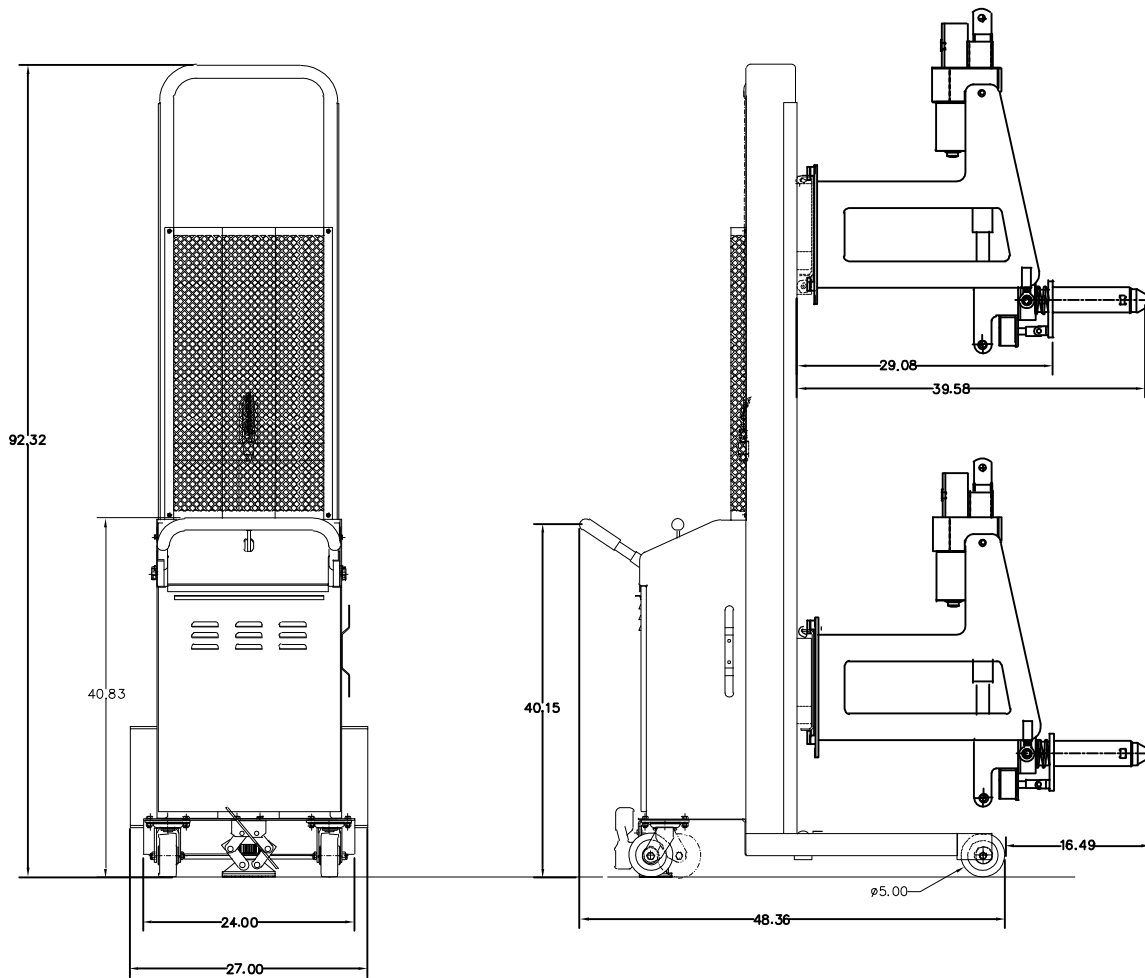

\*Unit shown with Presto B678

## SPECS AND OPTIONS

Electric Cart Attachment Capacity					
Roll Face Width	10"	20"	30"	40"	50"
Max Capacity	938lbs	577lbs	417lbs	326lbs	268lbs

\*Capacity varies based on mobile cart capacity.

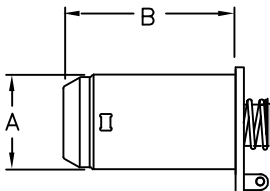

Standard Probe Options		
Type	"A"	"B"
3" Standard	2.875"	10.5"
3" Short	2.875"	6"
6" Standard	5.875"	10.5"
6" Short	5.875"	6"

Custom Probes Available Upon Request.



Counterweight



Full Powered



Rigid Probe