



LD1

Pneumatic Tip Lift

Hoist mounted roll handling equipment designed to quickly and safely lift and rotate a roll.

POWER REQUIREMENTS

90 PSI air and 115 volts, 60 Hertz, single phase, 7 1/2amps required on standard units. Unit equipped with 6-conductor coiled SO cable. All air (no electricity) units available upon request.

SPEED

Adjustable with pneumatic muffler on unit.

TIPPING RESTRICTIONS

No limit to cycles per hour.

WEIGHT

85 lbs with 3" standard probe.

CAPACITY

See chart on page 2.

PROBE

All Tip Lifts probes are interchangeable. Probes Feature a patented design that prevents a roll from being release unless the weight of the roll is supported. This prevent unintentionally releasing the roll when the operator is not ready.



*Unit shown with pneumatic tooth release



Handle Mounted Controls

Handle mounted controls allow the operator to tip the roll, release the roll (if unit has pneumatic tooth release) and control the hoist while keeping hands in a safe location.

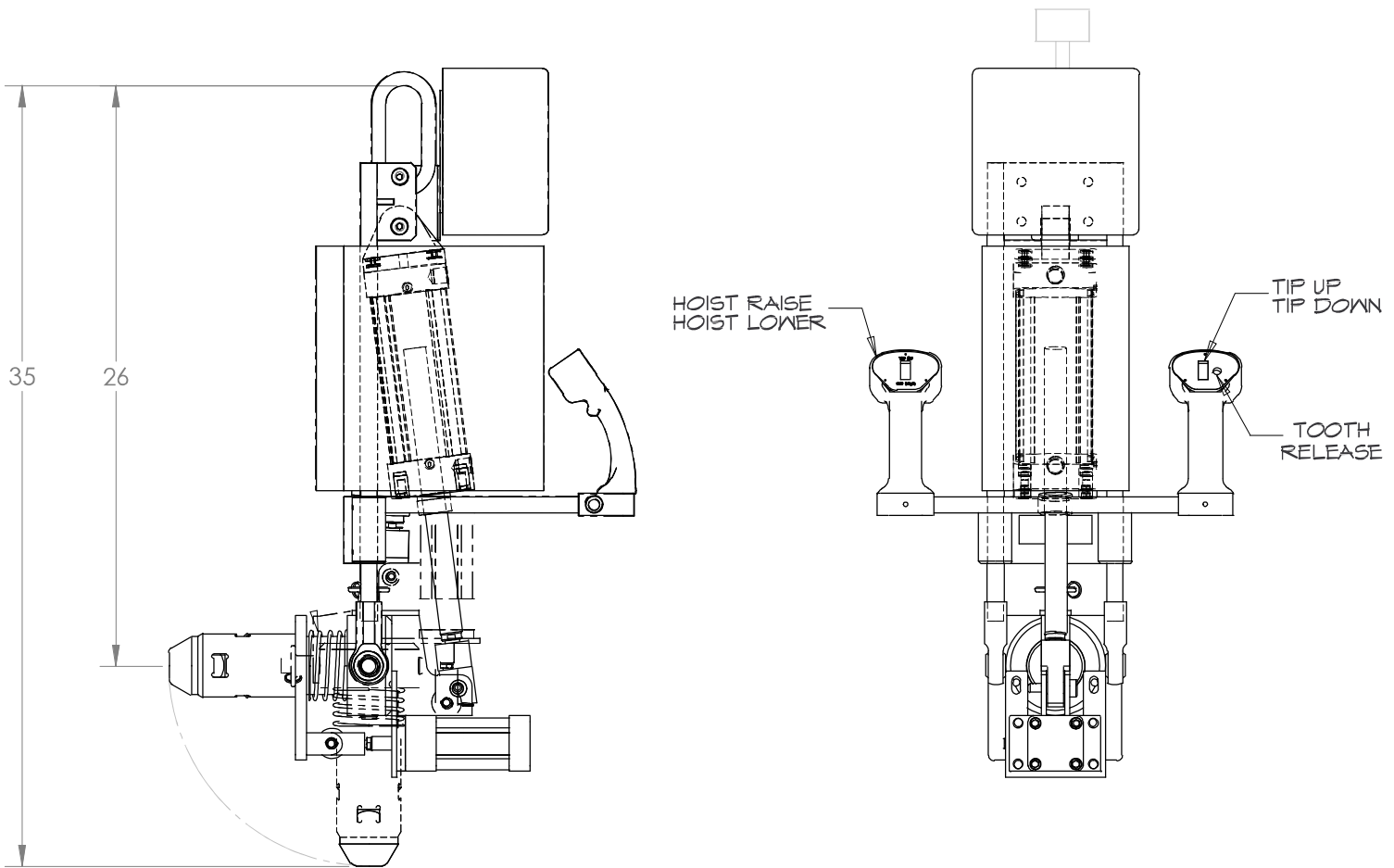

SPECS AND OPTIONS

LD1 Pneumatic Tip Lift Capacity						
Roll Face Width	4"	8"	12"	16"	20"	24"
Max Capacity	590lbs	421lbs	328lbs	268lbs	277lbs	197lbs

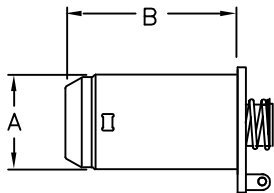

Standard Probe Options		
Type	"A"	"B"
3" Standard	2.875"	10.5"
3" Short	2.875"	6"
6" Standard	5.875"	10.5"
6" Short	5.875"	6"

Custom Probes Available Upon Request.

Manual Tooth Release

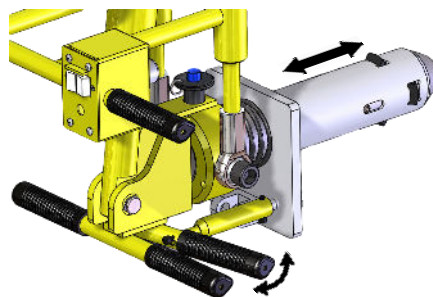

Pneumatic Tooth Release

