



# LS1

## Electric Tip Lift

Hoist mounted roll handling equipment designed to quickly and safely lift and rotate a roll.

### **POWER REQUIREMENTS**

115 volts, 60 hertz, single phase, 7 1/2 amps. Unit equipped with 6-conductor coiled SO cable. 90 PSI required to power pneumatic tooth release (optional).

### **SPEED**

Approximately 6 seconds per tip.

### **TIPPING RESTRICTIONS**

Not to exceed 25 tips per hour.

### **WEIGHT**

100 lbs with 3" standard probe.

### **CAPACITY**

See chart on page 2.

### **PROBE**

All Tip Lifts probes are interchangeable. Probes feature a patented design that prevents a roll from being release unless the weight of the roll is supported. This prevent unintentionally releasing the roll when the operator is not ready.



\*Unit shown with pneumatic tooth release



### **Handle Mounted Controls**

Handle mounted controls allow the operator to tip the roll, release the roll (if unit has pneumatic tooth release) and control the hoist while keeping hands in a safe location.

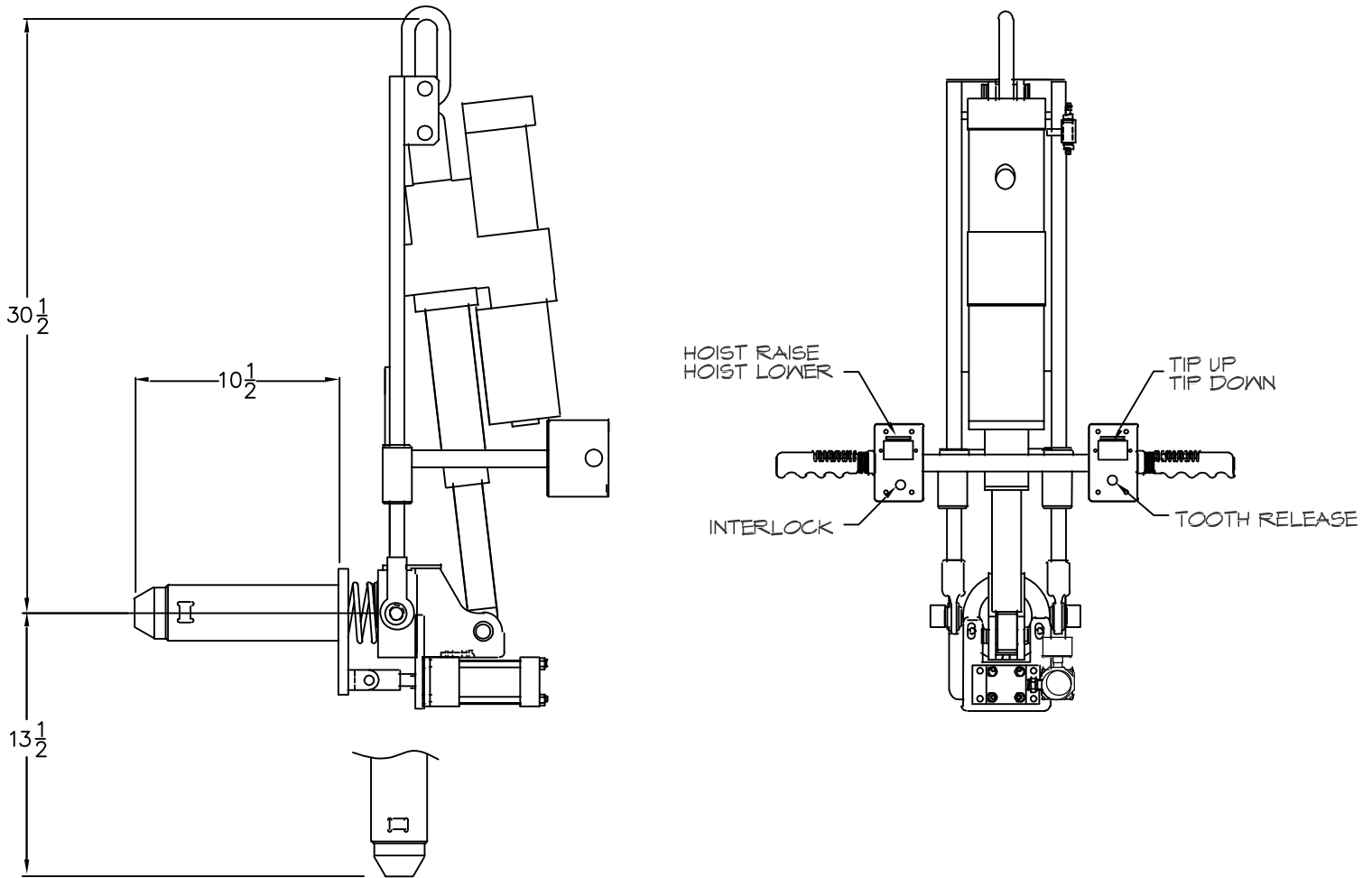

## SPECS AND OPTIONS

LS1 Electric Tip Lift Capacity							
Roll Face Width	10"	20"	30"	40"	50"	60"	70"
Max Capacity	830lbs	510lbs	370lbs	290lbs	230lbs	200lbs	170lbs

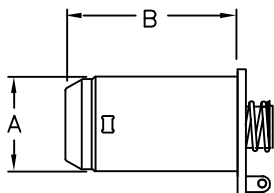

Standard Probe Options		
Type	"A"	"B"
3" Standard	2.875"	10.5"
3" Short	2.875"	6"
6" Standard	5.875"	10.5"
6" Short	5.875"	6"

Custom Probes Available Upon Request.

